



4580 W Roosevelt Rd. Hillside, IL 60162

Phone: 312-733-1098 Fax: 708-234-1351

SPECIFICATIONS

MODEL APO-S3118-0RI-18 (18 Gauge)

GENERAL

Fine quality hand-made sink formed of 18 gauge type 304 nickel bearing stainless steel.

DESIGN FEATURES

Bowl depth 9 inches with inside bowl dimensions 29" X 16" Over all 31" X 18"

Finish: Inside bowl surfaces polished to a uniform satin finish.

Underside: Five high density sound absorption pads covered with a thick rubberized insulation layer on all bottom surfaces.

Other: Drain opening 3 1/2".

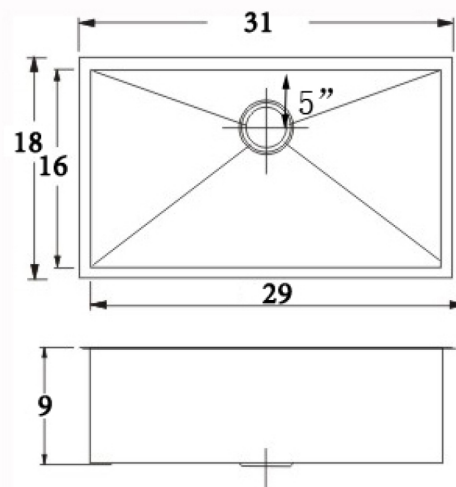

cUPC Certified

Minimum Cabinet Size: 33"

Product shall be specified as
APO-S3118-0RI-18

OPTIONAL ACCESSORIES:

Stainless Steel Bottom Grid: APO-G20S3118

Sink Drain: APO-SS01, APO-SS02



APO-SS01



APO-SS02

Warranty:

Limited Life Time warranty against manufacturer defects and craftsmanship.