

Single Hole Single Handle Lavatory faucet B486SPC/B486SBN

Apogee Faucets reserves the right to make modification and specification changes at any time. Please verify dimensions prior to installation.

Features & Benefits

- Top quality durable solid brass construction.
- Top quality durable ceramic disc valves exceed the industry longevity standards two times for a lifetime of durable performance.
- Elegant timeless style design.
- Single lever control for ease of operation.
- For single hole configurations.
- Maximum Flow Rate: 1.2 GPM @ 60PSI



Codes and Standards

These products meet or exceed the following codes and standards:

- ANSI A117.1
- ASME A112.18.1
- CSA B-125
- NSF 61/SECTION 9 & ANNEX G
- AB1953

Specified Model & Finish

| Model # | Description | Finish |
|---------|---|-----------------|
| B486SPC | Single Lever Handle Single Hole Lavatory Faucet | Polished Chrome |
| B486SBN | Single Lever Handle Single Hole Lavatory Faucet | Brushed Nickel |

Product Diagram

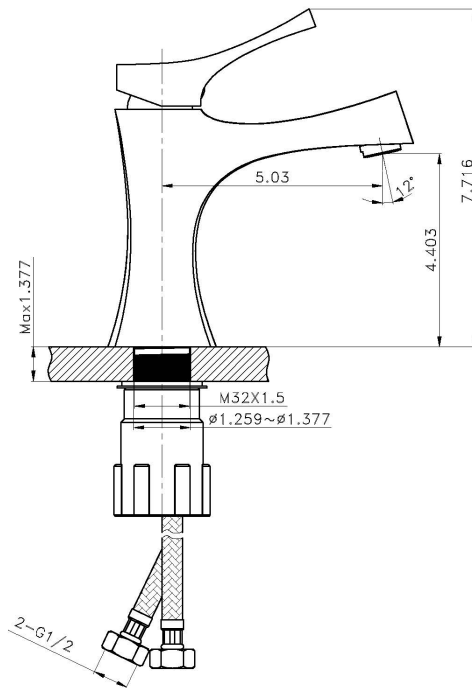

Parts Explore

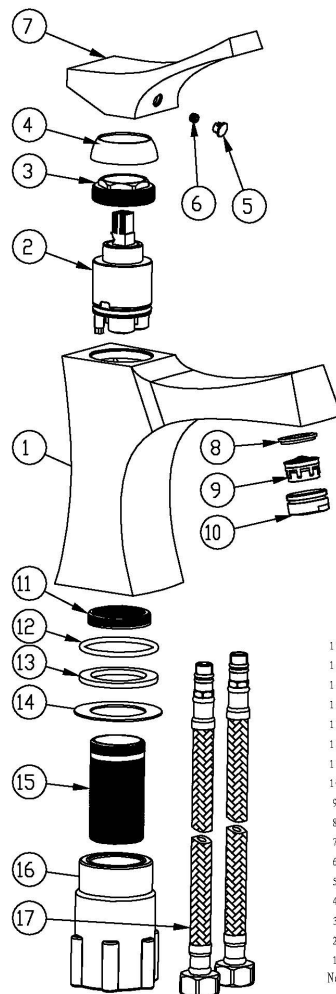

| | | | |
|-----|--------------|-----------------------|----------|
| 17 | 61714612 | SS Braided hose L=600 | 2 |
| 16 | 61302741 | ABS Lock-nut | 1 |
| 15 | 61300222 | Lock Screw | 1 |
| 14 | 61604941 | white washer | 1 |
| 13 | 61600542 | washer | 1 |
| 12 | 61504942 | O-ring | 1 |
| 11 | 61307422 | Screw thread ring | 1 |
| 10 | 61805600 | Aerator holder | 1 |
| 9 | 7653038-0241 | Aerator | 1 |
| 8 | 7656000-0342 | washer | 1 |
| 7 | 60915300-01 | Handle | 1 |
| 6 | 61100112 | Nail | 1 |
| 5 | 61800541 | Hot and cold label | 1 |
| 4 | 61803500 | Cup | 1 |
| 3 | 61302922 | Nut | 1 |
| 2 | 60715441 | Cartridge | 1 |
| 1 | 511433-0100 | Main Body | 1 |
| No. | Part NO. | Description | Quantity |