

LENOVA

4580 W Roosevelt Rd Hillside, IL 60162 www.Lenovasinks.com Phone: 877-733-1098

Special Design Patent “PermaClean Drain System”

SPECIFICATIONS

MODEL PC-SS-0Ri-S22

GENERAL

Fine quality sink formed of heavy duty 16 gauge, type 304 nickel bearing stainless steel.

DESIGN FEATURES

Bowl depth 10" with inside bowl dimensions 16" X 21", and over all 22-1/2" X 17-1/2".

Finish: Inside bowl surfaces polished to a uniform satin finish.

Underside: High density sound absorption pads covered with a thick rubberized insulation layer on all bottom surfaces.

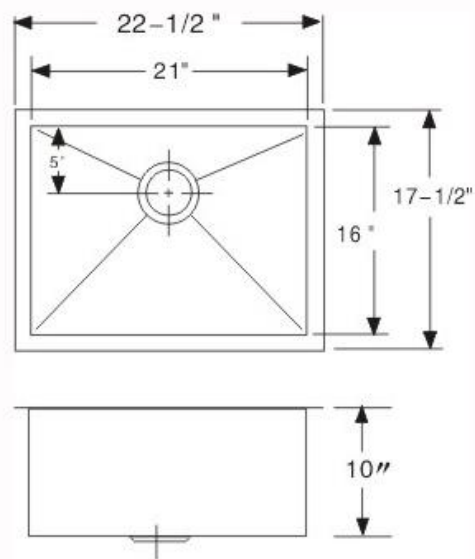

cUPC certified.

Minimum cabinet size 24"

Product shall be specified as PC-SS-0Ri-S22

ACCESSORIES:

1. The waste king adapter (for Waste King Garbage Disposal) is sold separately by request. List price for the waste king adapter is \$7.
2. The PermaClean Drain Kits (except waste king adapter), \$65 value, comes with the PermaClean Sink at no cost.



OPTIONAL ACCESSORIES:

Stainless Steel Grids: G0S3

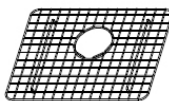

Warranty:

Limited Life Time warranty against manufacturer defects and craftsmanship.

Codes/Standards Applicable:

ASME A112.19.3/CSA B45.4

*Template and mounting clips are packed with every sink